

DRC
PZ24-12000011
07/17/2024

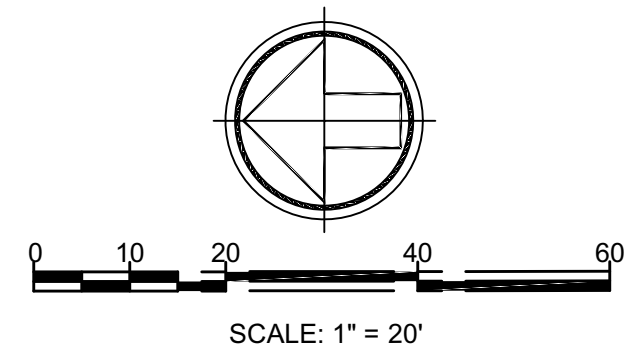

NOTES:

1. ALL EXISTING & PROPOSED GRADES ARE NAVD88.
NAVD88 = NGVD29 - 1.51
NGVD29 = NAVD88 + 1.51
2. MINIMUM F.F.E. OF PROPOSED BUILDINGS = 10.40 NAVD
3. FEMA FLOOD ZONE AH 7 (PORTION OF PARCEL 3), X (REMAINING SITE)
4. BROWARD COUNTY FUTURE CONDITIONS 2060 100-YEAR FLOOD MAP ELEVATION = 8.00 NAVD
5. WET SEASON WATER TABLE ELEVATION FOR PARCELS #1 AND #2 = 2.50 NAVD (BROWARD COUNTY CURRENT WATER TABLE MAP), FOR PARCEL #3 = 1.50 NAVD (BROWARD COUNTY FUTURE WATER TABLE MAP AND SOIL BORING DATA)
6. PROPOSED OFF-SITE DRAINAGE SYSTEM IN PUBLIC RIGHT-OF-WAY SHALL BE OWNED AND MAINTAINED BY THE CITY OF POMPANO BEACH.
7. AS PER CITY CODE, LANDSCAPING MATERIALS OTHER THAN SOD ARE NOT ALLOWED WITHIN 5' OF ANY PORTION OF CITY OWNED UTILITIES WITHIN THE PUBLIC STREET RIGHT-OF-WAY INCLUDING METERS, HYDRANTS, SERVICE LINES, ETC.
8. THE HORIZONTAL AND VERTICAL LOCATIONS OF ALL EXISTING UTILITIES SHOWN ON THESE PLANS IS APPROXIMATE AND BASED ON AVAILABLE AS-BUILT AND GIS MAP DATA AND HAS NOT BEEN VERIFIED. OTHER UTILITIES WHICH ARE NOT SHOWN ON THE PLANS MAY BE PRESENT. THE CONTRACTOR SHALL VERIFY THE HORIZONTAL AND VERTICAL LOCATIONS OF ALL EXISTING UTILITIES WITHIN THE PROXIMITY OF THE SCOPE OF WORK SUFFICIENTLY AHEAD OF CONSTRUCTION TO ALLOW FOR RE-DESIGN BY THE ENGINEER IF SUCH UTILITIES ARE FOUND TO BE DIFFERENT THAN SHOWN ON THESE PLANS. ALL EXISTING UTILITIES SHALL REMAIN AND BE PROTECTED UNLESS OTHERWISE NOTED ON THE PLANS.
9. EXISTING PUBLIC ROADWAY WITHIN THE PROJECT LIMITS AND POSSIBLY BEYOND WILL BE INSPECTED BY THE CITY ENGINEER, PUBLIC WORKS DIRECTOR, OR A DESIGNATIVE REPRESENTATIVE FOR DAMAGE DUE TO CONSTRUCTION PRIOR TO FINAL ACCEPTANCE. PARTIAL OR FULL MILLING AND OVERLAY OF THE EXISTING PUBLIC ROADWAYS MAY BE REQUIRED.
10. DURING DEWATERING OPERATIONS THE CONTRACTOR IS RESPONSIBLE FOR MAINTAINING A CONSTANT NEUTRAL WATER TABLE ELEVATION IN THE AREAS ADJACENT TO THE DEWATERING ACTIVITIES AND AROUND ANY NEARBY EXISTING STRUCTURES AND UTILITIES. A GROUNDWATER MONITORING AND RECHARGE PLAN MAY NEED TO BE DEVELOPED BY THE CONTRACTOR TO MITIGATE ANY ADVERSE EFFECTS CAUSED BY DEWATERING ACTIVITIES TO ANY STRUCTURES OR UTILITIES AROUND AND BEYOND THE LIMITS OF CONSTRUCTION.
11. SEE WATER AND SEWER PLANS, SHEETS CE1 THRU CE1D FOR UTILITY CONFLICT INFORMATION.

PAVING AND GRADING LEGEND

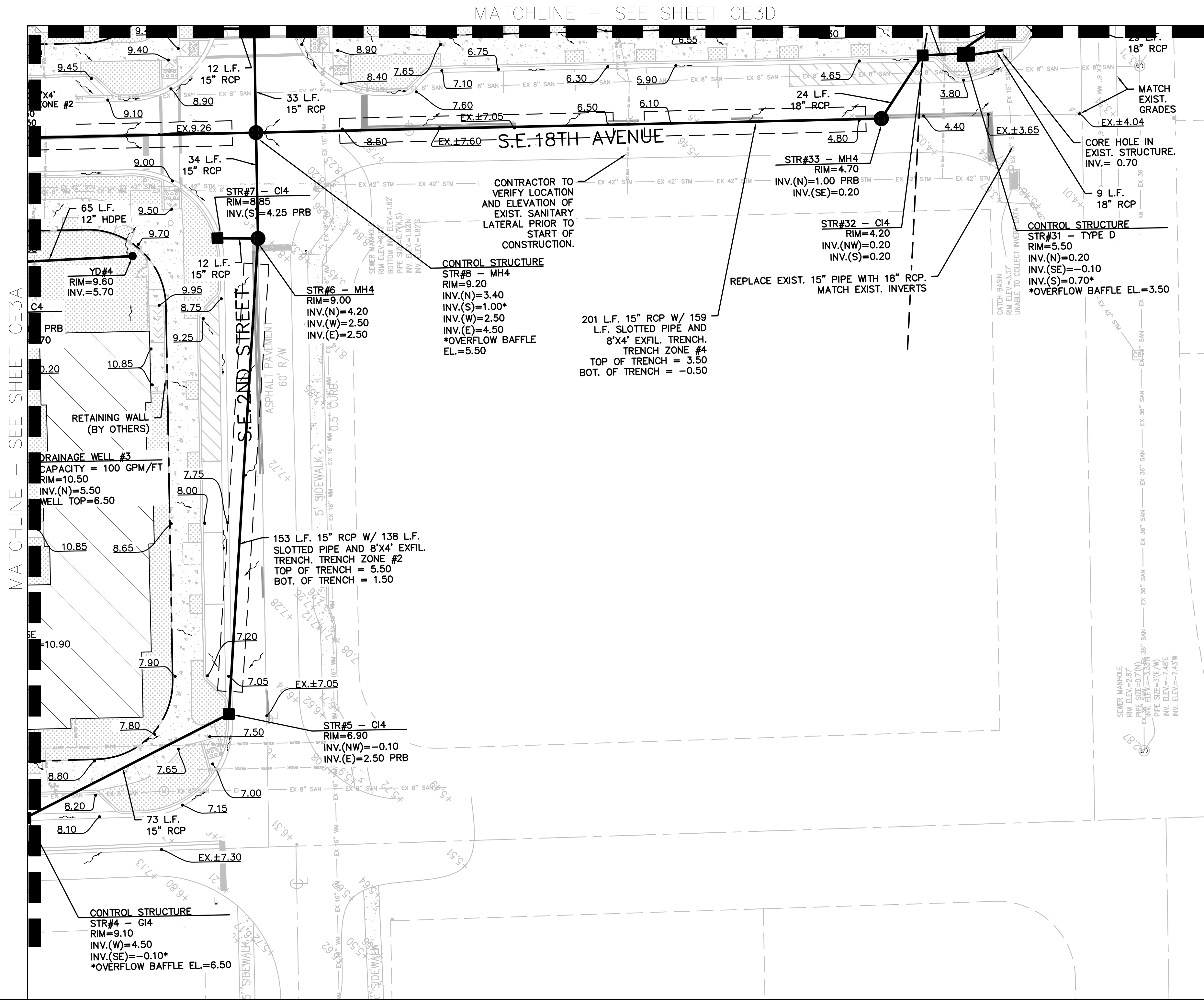
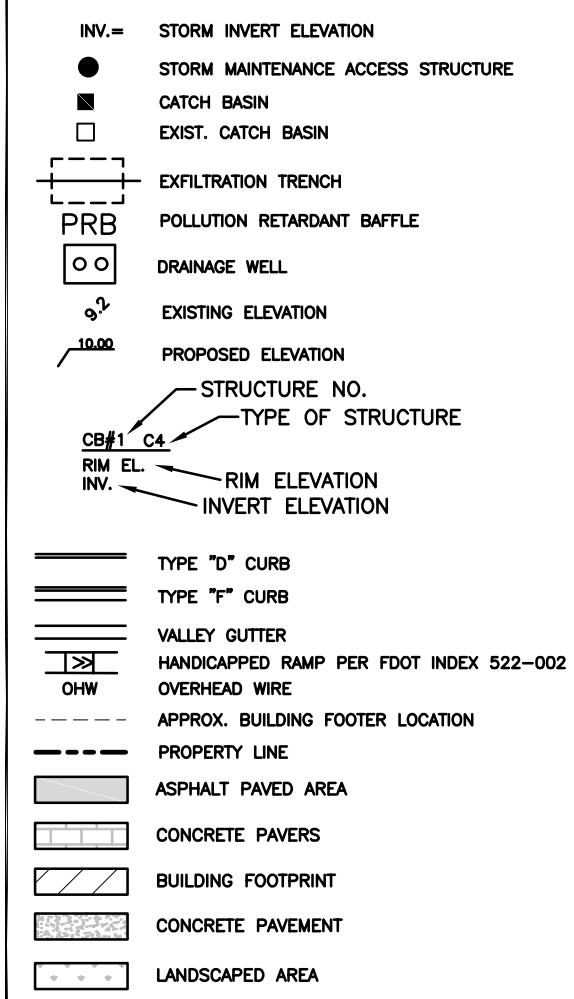

SDA ENGINEERING
ENGINEERING o SURVEYING o PLANNING

ENGINEERING AUTH. NO. 5634 SURVEYING LIC. NO. LB-6456
3410 N. Andrews Avenue Ext. • Pompano Beach, FL 33064
PH: 954-943-9433 • FAX: 954-783-4754

DRAWN BY: MJG

CHECKED BY: JFD

DESIGNED BY: MJG

APPROVED BY: S.D.A.

SCALE: 1"=20'

ATLANTIC ONE
MIXED-USE DEVELOPMENT
POMPANO BEACH, BROWARD COUNTY, FLORIDA
GRADING & DRAINAGE PLAN
SOUTHWEST

SEAL

FOR THE FIRM, BY:

Matthew J. Giani

ew J

Giani

DATE: 2024.06.10

16:32:15 -04'00'

MATTHEW GIANI, P.E.

FLA. P.E. No. 84229

DATE: APRIL 2024

JOB NO.

1136B.01

SHEET

CE2C

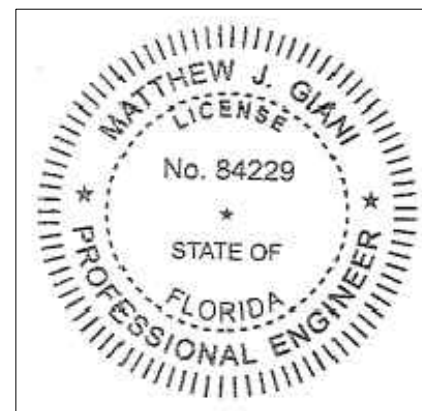

This item has been digitally signed and sealed by Matthew J. Giani on the date on the digital seal.

Printed copies of this document are not considered signed and sealed and the signature must be verified on any electronic copies.